

# HRCC SERIES

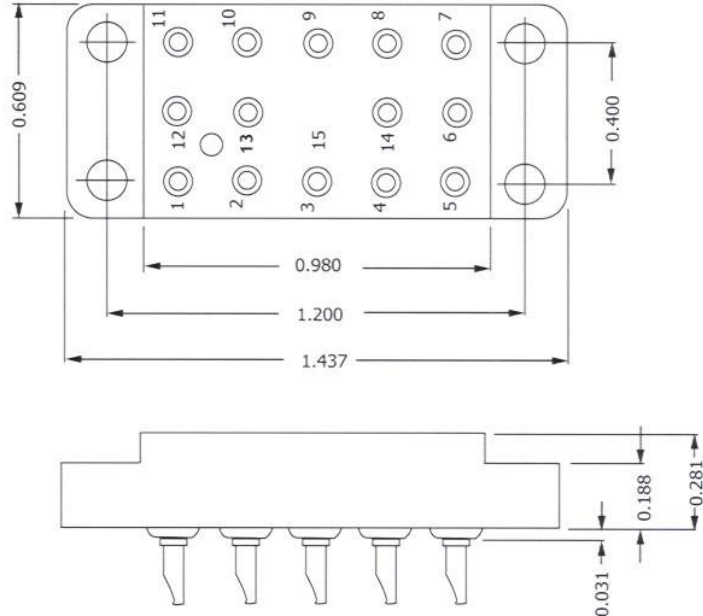
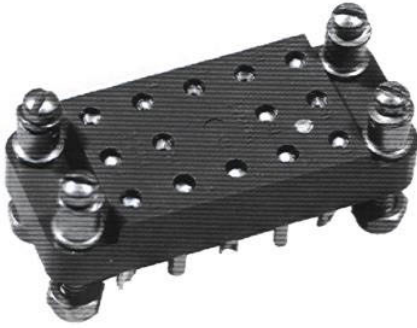

CONTACT DATA	CHASSIS MOUNTING DATA							
	CHASSIS THICKNESS	X-DIMENSION	BELOW CHASSIS	BELOW CHASSIS	ABOVE CHASSIS			
OPEN ENTRY	SOLDER CUP	3/16	.17	HRCC - 1		HRCC - 2		
		3/32	.14		HRCC - 31	HRCC - 32		
		1/8	.12		HRCC - 41	HRCC - 42		
		3/16	.17	HRCC - 5		HRCC - 6		
		3/32	.14		HRCC - 35	HRCC - 36		
		1/8	.12		HRCC - 45	HRCC - 46		
	EYELET	STRAIGHT	3/16				HRCC - 4	
			3/32				HRCC - 34	
			1/8					
		WIRE WRAP	0.045 SQ.	3/16	.17	HRCC - 718		HRCC - 719
			0.80	3/32				
				1/8				
CLOSED ENTRY	SOLDER CUP	3/16	.17	HRCC - 1K		HRCC - 2K		
		3/32	.14		HRCC - 31K	HRCC - 32K		
		1/8	.12		HRCC - 41K	HRCC - 42K		
		3/16	.17	HRCC - 5K		HRCC - 6K		
		3/32	.14		HRCC - 35K	HRCC - 36K		
		1/8	.12		HRCC - 45K	HRCC - 46K		
	EYELET	STRAIGHT	3/16				HRCC - 4K	
			3/32					
			1/8					
		WIRE WRAP	0.025 SQ.	3/16	.17	HRCC - 513K		HRCC - 18K
			1/2	3/32	.23	HRCC - 13K		
				1/8				

## ELECTRICAL

### Wire Size:

Solder Cup Type.....One #20 AWG  
 Eyelet Type.....Two #20 AWG or  
 Three #22 AWG

### Current Rating:

3 Amperes

### Withstanding Voltage:

Contact to Contact Sea Level..... 2700 VRMS Minimum  
 Contact to Ground Sea Level..... 1500 VRMS Minimum  
 Contact to Contact 70,000 Ft..... 560 VRMS Minimum  
 Contact to Ground 70,000 Ft..... 375 VRMS Minimum

## MECHANICAL

Creepage Between Contacts..... 0.17 Minimum  
 Air Space Between Contacts..... 0.11 Minimum  
 Contacts to Accept 0.030 ± 0.001 DIA. Pins

### Contacts:

Spring Temper Grade "A" Phosphor Bronze, or  
 Heat Treated Beryllium Copper  
 Gold Plated over Copper or Nickel Plate

### Mounting Hardware:

Special Studs, Screws, Lockwashers, and Nuts

### Insulation Material:

Choice of "MIL Approved" Thermosetting  
 Insulations (See Page 45)

### Temperature Ratings: -65°C to +125°C

Weight of Socket with Mountings: 0.43 oz.

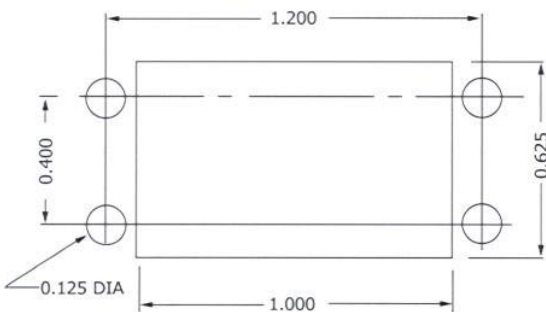

RECOMMENDED CHASSIS CUT-OUT